



TWO BEDROOM GROUND  
FLOOR SPACIOUS  
APARTMENT

PRIVATE AND VISITORS  
PARKING

WELL MAINTAINED  
COMMUNAL GROUNDS

Oakburn Walk, Jamestown, Alexandria, G83 9NJ

EVE Property are proud to present a well presented and proportioned ground floor two-bedroom luxury apartment within the modern and popular Oakburn Walk development. Built by Turnberry Homes and located within a quiet residential area with beautiful landscaped communal grounds and residents private parking.

Offers Over £125,000



## Property Description

EVE Property are proud to present a well presented and proportioned ground floor two-bedroom luxury apartment within the modern and popular Oakburn Walk development. Built by Turnberry Homes and located within a quiet residential area with beautiful landscaped communal grounds and residents private parking.

The entrance to the property is via a secure door entry system and boasts a fully carpeted communal close area. Upon entry through the front door you are immediately impacted by the space this property has to offer. The reception hallway offers fresh neutral decoration with en-trend wide panelled wood flooring, handy storage cupboard and with all rooms leading off. The bright spacious lounge showcases a beautiful large bay window with Juliette balcony which allows natural light to flood the room. This room has been thoughtfully decorated and designed by the current owner in cream and white finishes which continues as a theme throughout the property. Moving into the kitchen you are greeted with a shaker style grey fitted kitchen fully equipped with integrated washing machine, dishwasher, built in electric oven, four burner gas hob with under counter fridge and freezer included. The kitchen can accommodate a dining area and further benefits from neutral décor, fully tiled splash back, fitted worktops and a range of fitted units allowing for plentiful storage solutions throughout. The property offers two double bedrooms both freshly decorated in neutral tones with quality thick pile cream carpet and with the added benefit of built in fitted wardrobes. The master bedroom includes an en-suite shower room with electric shower, shower cubicle and white two piece suite. The family bathroom is partially tiled and offers three piece suite.





The property is further enhanced with full thermostatically controlled gas central heating with individual radiator thermostats, double glazing, secure door entry system and resident and visitors private parking. The property on offer has been very well maintained by the current owner and is located on the ground floor of a two storey building with only four properties.

Oakburn Walk is perfectly located between Alexandria Town Centre and Balloch, offering excellent choice of local supermarkets and amenities. Local rail and bus stations are a short distance, offering public transport to Dumbarton, Loch Lomond, Helensburgh and Glasgow City Centre. Road links to A82 and M8 are within a short journey.

58 Oakburn Walk, Jamestown, G83 9NJ

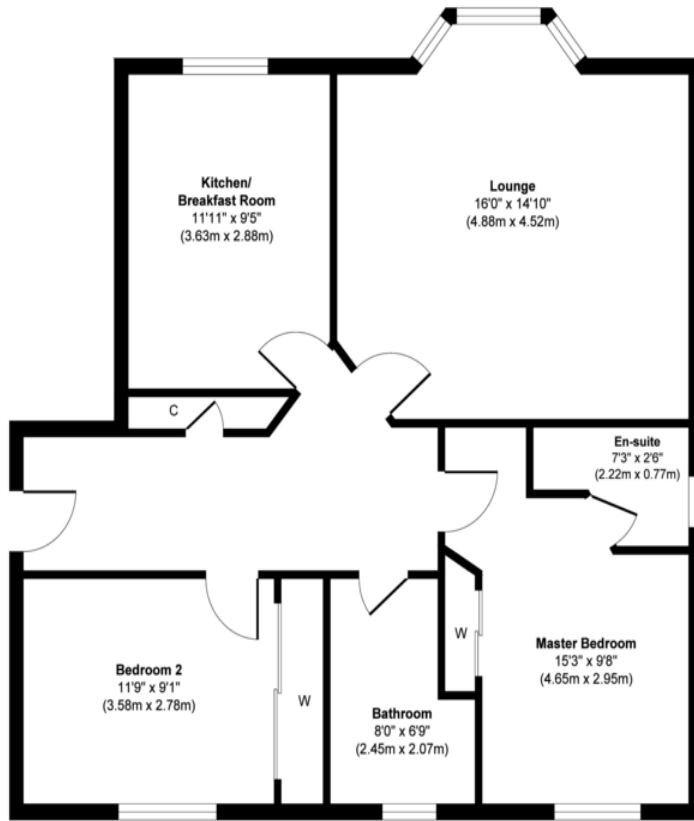

Floor Plan  
Approximate Floor Area  
861 sq. ft  
(80.02 sq. m)

Approx. Gross Internal Floor Area 861 sq. ft / 80.02 sq. m

Illustration for identification purposes only, measurements are approximate, not to scale.  
Produced by Elements Property

- LOUNGE**  
16' 0" x 14' 9" (4.88m x 4.52m)
- KITCHEN**  
11' 10" x 9' 5" (3.63m x 2.88m)
- MASTER BEDROOM**  
15' 3" x 9' 8" (4.65m x 2.95m)
- EN-SUITE SHOWER ROOM**  
7' 3" x 2' 6" (2.22m x 0.77m)
- BEDROOM TWO**  
11' 8" x 9' 0" (3.58m x 2.76m)
- BATHROOM**  
8' 0" x 6' 9" (2.45m x 2.07m)

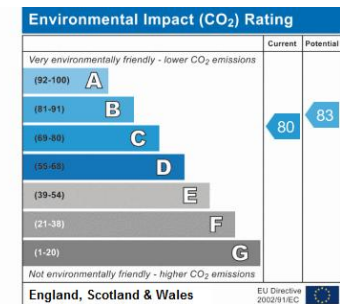
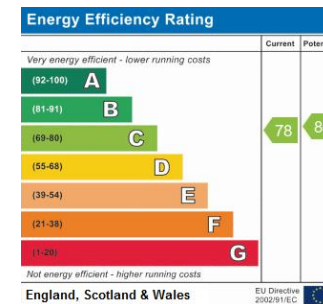

1 Herschell Street, Anniesland,  
Glasgow, Lanarkshire, G13 1HR

www.eve-property.co.uk  
0141 255 0020  
hello@eve-property.co.uk

Agents Note: Whilst every care has been taken to prepare these particulars, they are for guidance purposes only. All measurements are approximate and for general guidance purposes only and whilst every care has been taken to ensure their accuracy, they should not be relied upon and potential buyers/tenants are advised to recheck the measurements